



***product overview /
Produktübersicht 2013***

headsets / steuersätze



10324 CUBE Steuersatz ORBIT Z

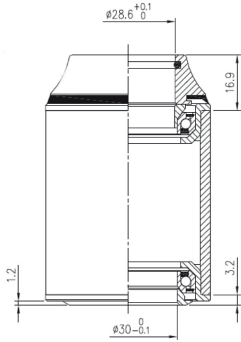

2011/2012 : Comp- Serie, LTD- Serie, LTD AMS 100 2011, AMS WLS Pro 2011, Tonopah Team SL, Race 2011, Kathmandu 2011, AMS 110 Race und SL 2011, Aerium Pro und Race 2011, Reaction SE 2011, Reaction Pro Mids. 2011, Reaction Pro, Race, SL 2012, AMS WLS Pro 2012, EPO 29er 2012, Cross Pro 2012, Tonopah Pro, Race, SL 2012, Delhi Pro 2012, Kathmandu 2012, SL Cross 2012, AMS Pro, Race, SL 2012, Aerium Pro und Race 2012

2013: Comp- Series, LTD- Series, Aerium HPA Race SL 2013, XMS 120 2013, EPO Dehli/Travel/Touring/Reaction 2013, alle AMS WLS 2013, alle Acces WLS 2013

10325 CUBE Steuersatz ORBIT Z-t+1 1/8 Reduzierhülse

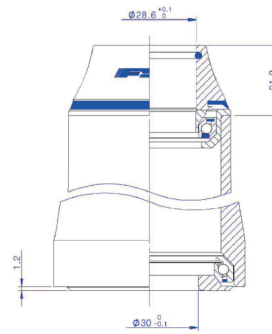

2011/2012: EPO shadow black 2011 u. StVZO, AMS 130 Race, SL 2011, AMS 150 Race, SL 2011, Agree Pro, SL 2011, Litening HPT 2011, EPO shadow black 2012 u. StVZO, AMS 130 SL, SLT 2012, AMS 150 Race, SL 2012, AMS 29er Race, SLT, Agree Pro, SL 2012

2013: Access WLS GTC ,2013, Reaction GTC Pro, Race, SL 2013, Elite HPC Race teamline 2013, Reaction GTC SL 29er 2013, Access WLS GTC 2013, AMS 100 HPC Race team 2013, Stereo HPC Pro 2013, AMS 130 2013, AMS 130 Race 2013, AMS 29er 2013, AMS 130 SE 2013, Stereo Super HPC 160/140 2013, AMS 100 Super HPC 29/26 2013, Elite Super HPC 29/26 2013, Reaction HPA 29/26 2013, alle Rennräder 2013, Cross Race Räder 2013, EPO Nature 2013

10326 CUBE Steuersatz ORBIT 1,5 R

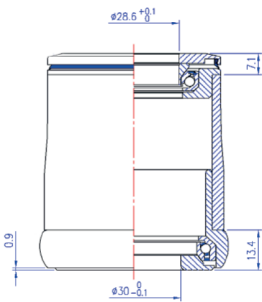

2011/2012 : Stereo WLS 2011, Stereo Team 2011, Stereo Pro 2012, Fritz Pro 2012

10327 CUBE Steuersatz ORBIT mit Alu- Kappe

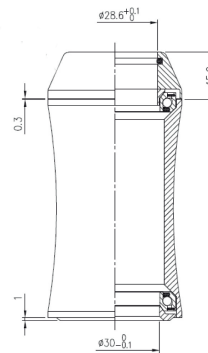

2011/2012: Hyde Team, SL, Hooper Pro 2011, Hyde Race; Editor 2012

2013: Hyde Team, SL, Hooper Pro 2013, Hyde Race; Editor 2013

10328 CUBE Steuersatz ORBIT I mit Carbon- Kappe

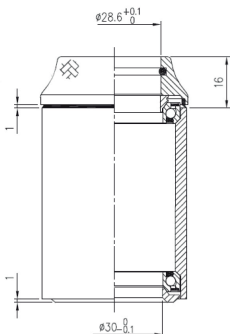

2011/2012 : Aerium HPC Pro, Race 2011, Aerium HPC Pro, Race 2012

10329 CUBE Steuersatz Gravity 1/DX Pro 1+1,5 Konus

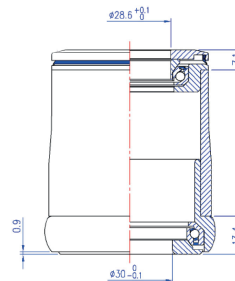

2011/2012: Hanzz 2011 und 2012

2013: TWO 15 2013, Hanzz 2013

